



PRIMARY SCHOOL VISITS 2016

Year 6 / Pupils & Parents / June 13th 2016



MRS HELEN JONES

Head teacher of Maesteg School

SCHOOL RULES

- Respect so that you can learn
- Respect your teachers
- Respect other pupils
- Respect your environment
- Respect deadlines
- Respect your uniform
- Respect yourself

- **LEARN.**
- Leave mobiles in bag and remove coats before entering the class.
- Ensure that you have all the necessary equipment
- Arrive on time
- Respect all staff, pupils and your learning environment.
- Now work hard and **STRIVE** to produce your best.



IMPORTANT DATES

- Thursday June 30th ~ Thursday 30th June
- Tuesday July 5th - July 15th ~ Invited at a mutually convenient time to meet your child's 2 tutors
- Thursday July 14th ~ Year 5 Pupils & Parents' Evening
~ Year 6 Pupils & Parents cordially invited

SCHOOL UNIFORM

BOYS

- Black and Amber Tie
- Black V neck long sleeved jumper/cardigan with school logo.
- White shirt
- Black formal trousers
- Black Socks
- Black shoes



GIRLS

- Black and Amber Tie
- Black V neck long sleeved jumper/cardigan with school logo.
- White shirt
- Black skirt/black formal trousers
- Black Socks/ tights
- Black low heeled shoes

PE KIT

Boys PE Kit ~ School rugby jersey, black shorts or black tracksuit bottoms, black training top, trainers school socks, boots.

Girls PE Kit ~ Black Training top, black shorts or black tracksuit bottoms/leggings, trainers.



SCHOOL EQUIPMENT

- School Bag (big enough for A4 files, gym kit and dry lunch if needed)
- Pencil case: Pens / drawing & colouring pencils, ruler, eraser, highlighters.
- **TOP TIP: Cover books with clear plastic – it helps waterproof the exercise books**



GETTING AROUND

- To help everyone find their classes, we have designed a colour coded floor plan of the school.

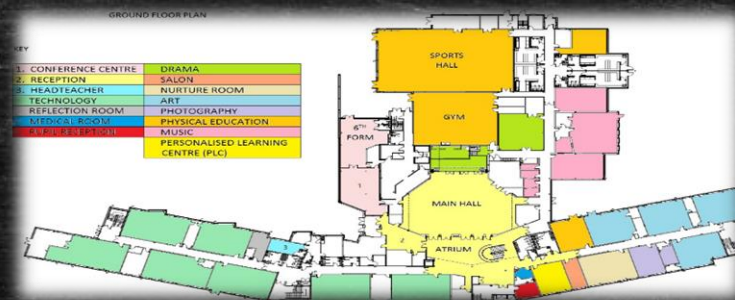
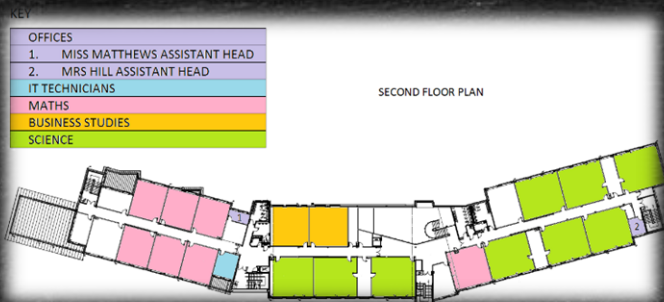

- There will be lots of friendly faces to help you find your way. It's a big school but once you know the layout, it will be fine.

SCHOOL DAY – PART 1

- We operate a 2-week timetable alternating between week 1 and 2 throughout the year. This can be checked on the school calendar to avoid confusion especially after holidays.
- W/C September 5th will be Week 1
- W/C September 12th will be Week 2

■



1Mon	1Tue	1Wed	1Thu	1Fri
Tutor Time KHE E04	Tutor Time KHE E04	Tutor Time KHE E04	Tutor Time KHE E04	Tutor Time KHE E04
Numeracy AON H03	Science ADL S03	Pse KHE E04	Maths ADS T07	Core Subie KHE E04
Games RFD	Science ADL S03	French NCN L03	Science MCT S04	Welsh ATT L06
Numeracy AON E07	French NCN L03	Info Tech TBK BI02	Games LCT	Maths ADS T07
Technology SWM T03	Core Subie KHE E04	Games LCT	Core Subie KHE E04	Creative A SJS CA2
Core Subie KHE E04	Maths ADS T07	Core Subie KHE E04	French NCN L03	Literacy ATR H03

2Mon	2Tue	2Wed	2Thu	2Fri
Tutor Time KHE E04	Tutor Time KHE E04	Tutor Time KHE E04	Tutor Time KHE E04	Tutor Time KHE E04
Core Subie KHE E04	Core Subie KHE E04	Pse KHE E04	Core Subie KHE E04	Science KBY S02
Creative A SJS CA2	Literacy ATR H03	Science KBY S02	Creative A SPY CA16	Creative A SPY CA16
Maths ADS T07	Numeracy AON E08	Core Subie KHE E04	Info Tech TBK BI02	Core Subie KHE E04
Welsh ATT L06	Technology SWM T03	Welsh ATT L06	Core Subie KHE E04	Maths ADS T07
Games CBS	Core Subie KHE E04	Literacy ATR H03	Science ADL S03	Maths JCS M04

SCHOOL DAY – PART 2

- Everyday starts at 8.40am for all our pupils.
- Detailed timings of our school day:
 - Tutor time 8.40-9.00
 - Lesson 1 9.00am-10.00am
 - Lesson 2 10.00am-11.00am
 - Break 11am-11.15am
 - Lesson 3 -11.15am – 12.15pm
 - Lesson 4 -12.15pm-1.15pm
 - Lunch 1.15pm-2.00pm
 - Lesson 5 2.00pm-3.00pm



SCHOOL DAY – PART 3

- Lessons finish at 3.00pm and we extend a warm welcome to all pupils who wish to stay for Power Hour Activities which are academic, cultural and sporting.
- If pupils remain in school for Power Hour Activities the school day will end at 4.00pm.



LUNCHTIME

- There is $\frac{3}{4}$ hour for lunch.
- There is plenty of choice from: cooked dinner of the day, jacket potatoes and lots of fillings, sandwiches, hot and cold baguettes, wraps, pizza, fruit, yogurts, water and fruit juice.
- We also have a breakfast club which is open to all pupils at 8am, serving tea and toast.
- At break, you can have toast and bacon rolls as well as cold drinks.



CASHLESS CATERING

- Maesteg operates a cashless catering system for school meals. It is a biometric system that recognises the thumb print of your child at the tills and at the revaluation pay points. This means that no cash will be accepted at the Till Points in the canteen.
- Currently there are two payment options available:
 - On-line payments; Coin and note payments at the revaluation pay-points situation in the school atrium.
- Please see our Cashless Catering Page on our school website for further details.
- Parent-Pay: access child's account to see what he/she is having for lunch and at break. Can make payments wherever you see Pay Point Sign (Filco and Premier Local Shops)



TEACHING CLASSES

- Children will be placed in carefully constructed teaching groups with other year 7 pupils.
- They will be with 3 different teachers for most of their timetable following our new year 7 Challenge Curriculum.
- They will have different teachers for Maths, French, Welsh and PE.



HOUSE SYSTEM

- Every student and all adults at Maesteg School have been allocated a house:
- **Cadrawd – Head of House – Miss Annmarie Tucker**
- **Cynwyd – Head of House – Miss Carley Hughes**
- **Llynfi - Head of House - Mrs Kate Hopkins-Sparkes**
- **Daren – Head of House – Mrs Lisa Ward**



HOUSE SYSTEM CONTINUED

- House competitions throughout the school year – Eisteddfod and Sports Day, Inter-house Competitions, Competitions to name your House logo and House Anthem, Charity Raising Events.
- Opportunity to earn house points for doing things well: going the extra mile in terms of homework; supporting a teacher in a classroom.
- Also for making an effort in class, in homework, bringing all your books, making sure you have a pen and pencil, using your planners ..well. In fact – everything.



HOUSE TUTOR GROUPS

- There will be 2 tutors with every tutor group
- There will be a designated House Section of the School
- All year 6 pupils carefully sorted into mixed year tutor groups.
- Tutor time will last for up to 20 minutes a day.
- Year 6 pupils will have the benefit of being able to talk to pupils who have experienced year 7 and the transition to Maesteg School.



YOUR FIRST DAY

- Make sure to arrive before bell goes for registration at 8:40 am.
- Make your way to the main hall (where you saw Beauty and the Beast.)
- Your Heads of House and one of your new tutor group will be there to take you up to your new tutor group who will all be dying to meet you.
- You will spend an hour in your group before being escorted to your first lesson

TRAVEL TO SCHOOL

- All bus passes are issued by the Local Authority. Questions relating to transport must be directed to Mr Tony Hart at BCBC. Tel 01656 642653 or email: tony.hart@bridgend.gov.uk
- Many of our students walk to school or bring their own bicycles which you can keep safe in the bike storage areas in the school.





OUR WEBSITE

- Please visit our website at:
www.maestegcs.bridgend.sch.uk

